

IDEA BOOK
SLIDING SYSTEMS
HIGH ON PERFORMANCE
LOW ON BUDGET



Hettich

IDEA BOOK
SLIDING SYSTEMS
HIGH ON PERFORMANCE
LOW ON BUDGET



Ergonomics, design and functionality get people excited about sliding motion.

This ideabook showcases sliding concepts you'll love ☺

IDEA BOOK
SLIDING SYSTEMS

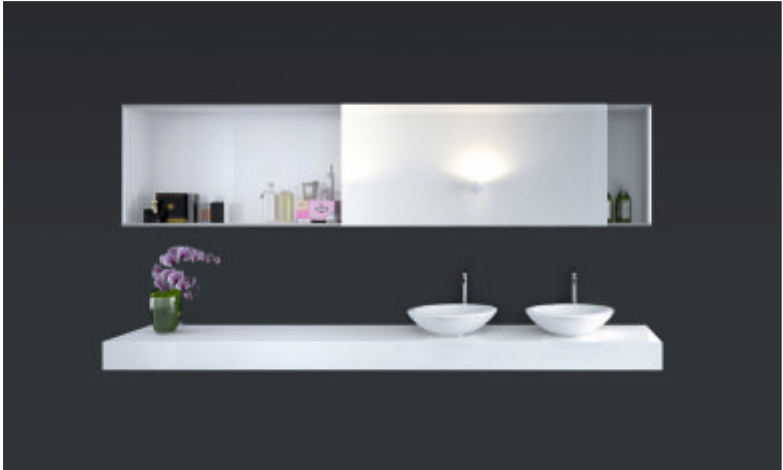

SIGNIFICANCE OF STORAGE SPACES IN YOUR WARDROBE

Wardrobe is not just a piece of furniture used for storage; it is also a reflection of one's personality and lifestyle. In this Idea Book, we showcase sliding fittings viz. Slideline M, TopLine M and SlideLine 16, which are innovative in design and currently in vogue.



Gender & Status

Every utilitarian furniture concept revolves around gender, and hence makes it gender-centric. The details will vary from finishes to accessories to form. A diverse range of accessories from Hettich will support the needs of men and women alike, ranging from storage of shirts to trousers to gowns and dresses to storing compact items like wallets to watches to belt and ties.



Lifestyle

The furniture will again vary from the different trendy lifestyle each individual embodies from time to time. We are already surrounded by them in our day to day lives. For example, men who like to collect neckties and cuff-links or women fond of acquiring exquisite bags and shoes or gorgeous gowns have nothing to worry about. Innovative Hettich furniture fittings and accessories are here for you.



Your organizing preferences

A very subjective scenario to cater to. Some people hang everything, including t-shirts. Some people prefer to fold their pants in shelves, while others fold their trousers over a hanger. Some like to use shelves, while others like drawers. Think and choose from our wide range of Hettich accessories and organizers, which resonate with your style.



Security

Apart from the basic function of storing, wardrobe demands a sturdy locking mechanism which not only provides function but aesthetics too. Hettich provides wide range of single to multi door locking solutions to smart locks, i.e RFID lock system ensures safety in all angles.



PLUS

Simple yet effective

Bed Room | Wall Unit

The centrepiece embodies a visual lightness which focuses on memorable souvenirs and artifacts. The linearity towards the whole furniture piece which is pushed back, automatically brings the oak laminated cabinet to attention.



FITTINGS USED

- SlideLine M
- Onsys hinge
- Lift up

CMF USED

- Oak & Gothic grey
- MDF
- Matte finish

GRID

A reality with different frames

Living Room | Showcase Unit

The bright shutters not only bring character to the piece but the environment as well. This wall hung unit showcases contemporary zines, books and items which make the art of reading fun.

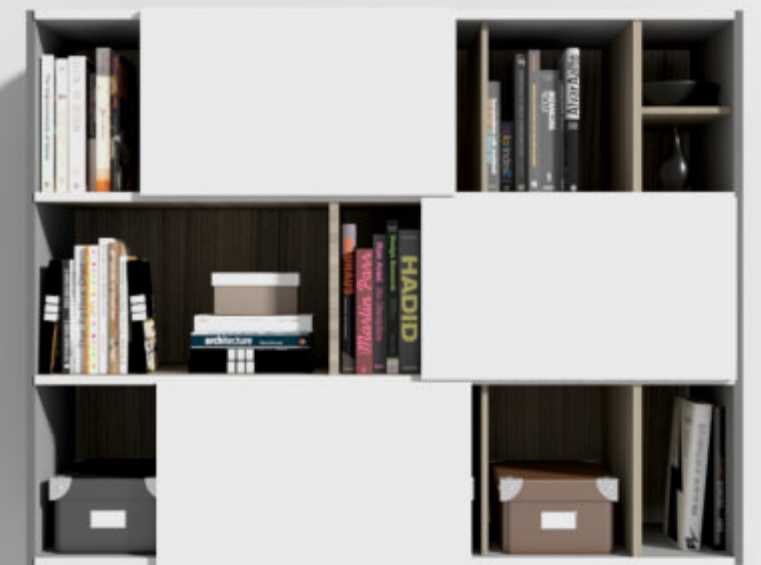

FITTINGS USED

- SlideLine M

CMF USED

- White & Grey
- MDF
- Matte finish

EDGE

*A little more than yesterday,
a little less than tomorrow*



Hallway | Storage Unit

When the magic begins with a slight touch. The moving shelves housing small souvenirs and items which are best suited in a hallway setup with the most trending magazines. The center portion divides the depth into two sections making it easy to display objects.



FITTINGS USED

- SlideLine M
- KA drawer runner
- Lift up

CMF USED

- Sky blue & Walnut
- MDF & Acrylic
- Matte finish

LUSCENT

*Reflecting perfection,
while reflecting distinctiveness*



Vanity | Storage Unit

This not only counts as a vanity but an essential unit for makeup and much more. The tinted plexi glass SlideLine M shutters just open up a new area and new variety of choice which brings in your own sense of comfort and liking.



FITTINGS USED

- SlideLine M
- Quadro drawer runner

CMF USED

- Oak & Soapstone grey
- MDF & Acrylic
- Matte finish

NOBLE

*The more you are happy,
the more you shine*



Kids Room | Storage Unit

A simple yet effective storage unit which encompasses a small utility tray for your essentials and toys. Let the kids have a gala time with the fun experience of sliding. The back surface also acts as a viewing mirror for the kids ever changing expressions.



FITTINGS USED

- SlideLine M

CMF USED

- Mellow yYellow & Gothic grey
- MDF & Mirror
- Matte finish

JANOT

*Talking about utility?
Experience the limitless!*



Utility Room | Janitor Storage Unit

Transparency is the key. A perfect combination of storage space, which allows you to keep items from toiletries to cleaning agents of various sizes. The use of glass as the back panel of the moving shelf emits an immediate lightness to the piece.



FITTINGS USED

- SlideLine M
- Onsys hinge
- InnoTech

CMF USED

- Gothic grey & Pale pink
- MDF & Acrylic
- Matte finish

SLIDELINE M

TECHNICAL DETAILS

- ▶ 1- 2 track, bottom-running sliding door system
- ▶ Overlay / Inset door position
- ▶ For wooden doors, aluminium-framed doors and glass doors
- ▶ Door weights up to 30 kg
- ▶ Door width 300-1800 mm
- ▶ Profiles for shelf thickness 15/16 mm,18/19 mm, 22 mm, 25 mm
- ▶ +/- 2 mm height adjustment
- ▶ Silent System with activators that can be positioned anywhere
- ▶ Tested to DIN-EN 15706, level 3

Door size and door weight

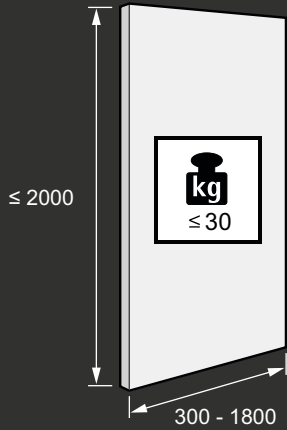

Installation Video



<https://youtu.be/VMPw68Ah24w>

Number of door wings and door position / Silent System

	Overlay		Inset		
	1-door	with several doors	1-door	2-door	3-door
Soft closing					
Soft opening					
Soft colliding					

Customize to your imagination

Free moving sliding door system for showcases

01 | 1200 x 450 x 1600

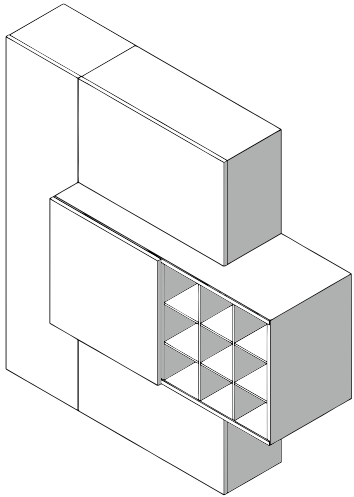

02 | 1400 x 450 x 1100

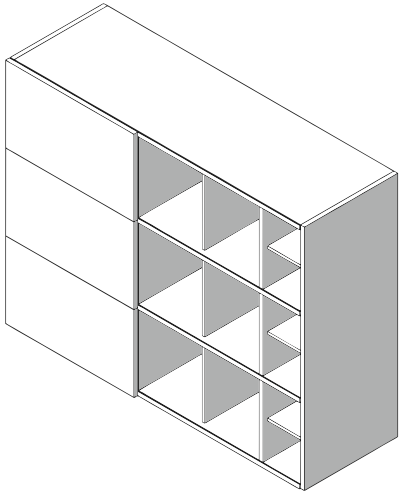

03 | 1800 x 400 x 1800

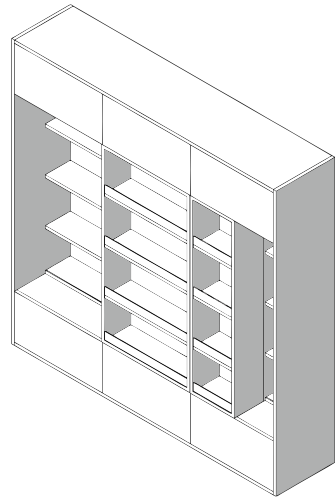

04 | 1350 x 350 x 2300

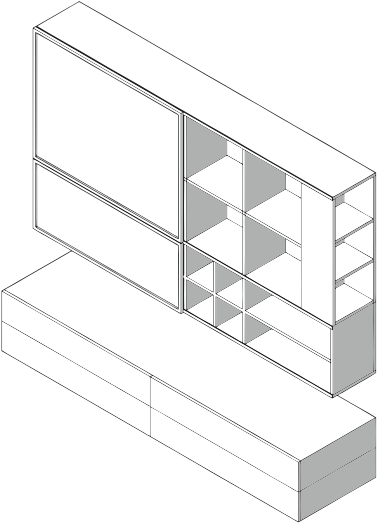

05 | 1900 x 450 x 1600

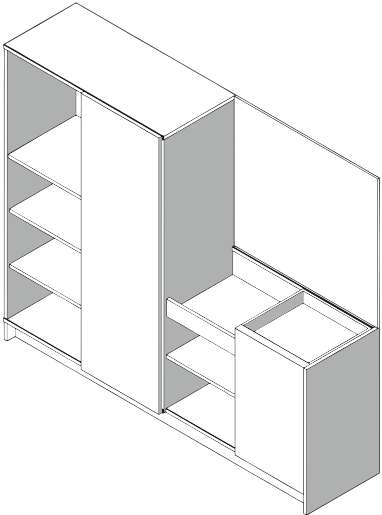

06 | 1500 x 500 x 2100

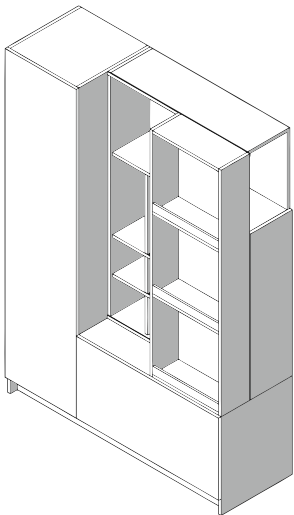

PLANE

*In a world full of noise,
be a voice, not an echo*



Living Room | Entertainment Unit

A geometric yet minimal looking TV unit can make the whole space luxurious. This TV unit comes with a mesmerizing simple line composition, breathtaking style and unique in-built storage unit. It uplifts your house from a regular house to a beautiful exclusive abode.



FITTINGS USED

- TopLine M
- Sensys hinge
- Quadro drawer runner

CMF USED

- Chest nut & White
- MDF
- Matte finish



SLICK

*Away with convention,
give me freedom*



Kitchen | Pantry Unit

Large storage area for pantry unit, which not only gives the user a pragmatic experience but a scope to view and function things with ease. Enough room has been provided in the internals with maximum storing of cutlery and jars.



FITTINGS USED

- TopLine M
- Sensys hinge
- CargoTech

CMF USED

- Chest nut & White
- MDF
- Matte finish

JARVIS

Oasis in the midst of hustle

Hallway | Storage Unit

A cloak room which houses your coats to muddy shoes to raincoats and more. A perfect use of horizontal linearity which slides and glides with ease, avoiding any disturbance in the passage area.



FITTINGS USED

- TopLine M
- Sensys hinge
- Cargo shoe rack

CMF USED

- Gothic grey & Denim blue
- MDF
- Matte finish

FOCAL

*Busy like office,
calm like home*



Home Office | Workspace

A basic reflection of a cubicle which pops out white in the centre as a focus area. The use of storage has been carried out with an effective yet an easy to use sliding mechanism where you can hoard your files, rolls, books and put snapshots over the soft board, remembering the good old times.



FITTINGS USED

- TopLine M
- Onsys hinge
- Aluminium profile

CMF USED

- Chest nut & Grey felt
- MDF & Frosted glass
- Matte finish



SLASH

When you are too serious about your relaxation



Kids Room | Wardrobe With Seating

A play of angles which excites the young. An illuminated sitting space which brings out the character of the whole space. A generic touch to the internals and the easy and effortless gliding of the shutters, will surely bring a smile to your child's face.



FITTINGS USED

- TopLine M
- KA drawer runner

CMF USED

- Walnut & Brass
- MDF & Felt
- Matte finish

SWIPE

*Things remain constant,
ambience goes along with you*



Bedroom | Wardrobe Cum Dressing

A sought after balance of a dressing and a wardrobe. The subtle link of different coloured panels to the sitting surface, creates a flow and does not disturb the overall ambience of the room.



FITTINGS USED

- TopLine M
- Cargo shoe rack
- Sliding door cylinder lock

CMF USED

- Gothic grey & Sky blue
- MDF & Mirror
- Matte finish



TOPLINE M

TECHNICAL DETAILS

- ▶ 2-track, top running sliding door system
- ▶ Overlay door position
- ▶ For wooden doors
- ▶ Door weight up to 35 kg
- ▶ Door height up to 2300 mm
- ▶ Door width 500 - 1250 mm
- ▶ Door thicknesses 15, 16, 18, 19 mm
- ▶ 2 opening versions: fully flush or offset when using projecting handles
- ▶ Tested to EN 15706, Level 2

Door size and door weight

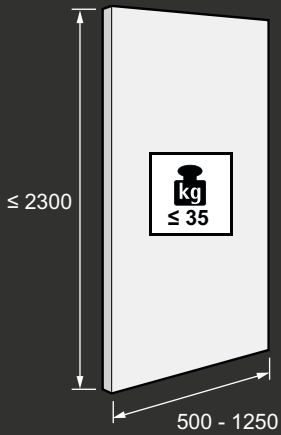

Installation Video



<https://youtu.be/8VBixkEY8QA>

Number of door wings and door position / Silent System

Soft closing

2-door



3-door



Design Flexibility

Top running sliding door system for wardrobes

07 | 4000 x 600 x 2100

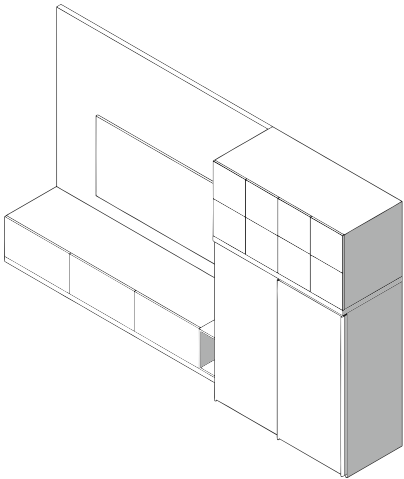

08 | 1500 x 600 x 2100

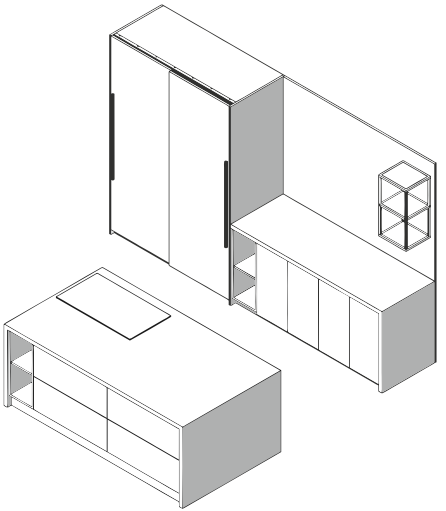

09 | 2800 x 600 x 2100

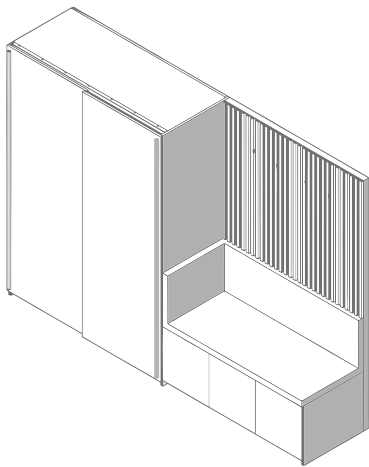

10 | 2500 x 600 x 2100

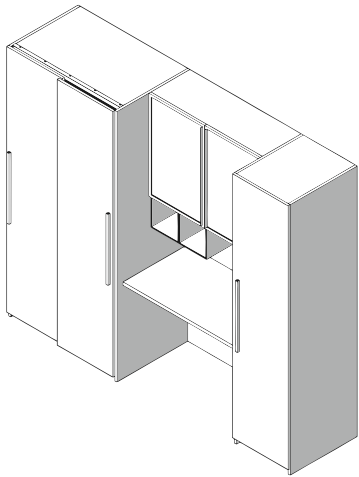

11 | 3000 x 600 x 2300

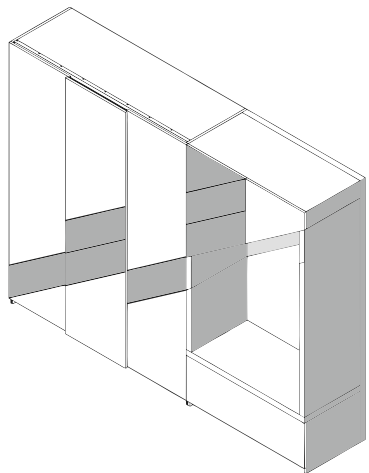

12 | 2400 x 600 x 2100

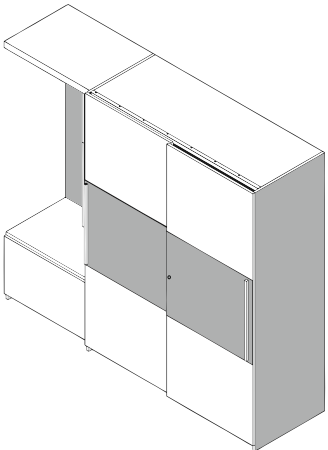

[illegible]This image shows a single sheet of white paper with horizontal ruling lines. The lines are evenly spaced and run across the width of the page. There are no margins, text, or other markings on the paper.

www.estiatrade.gr

Sliding Systems | IdeaBook | October 2021



Hettich